

Einnova Solarline

invented for solar

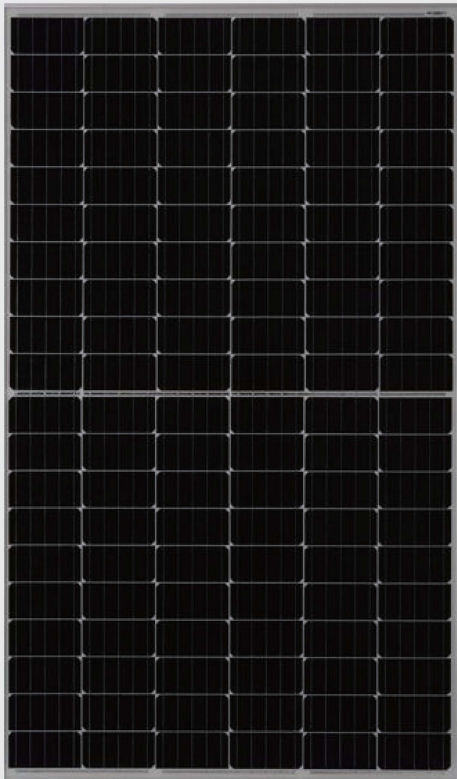

PERC Mono Crystalline Solar Module ESM 325/330/335/340/345H

Einnova Solarline modules strictly comply with IEC standards, following stringent BOM quality testing and 100% EL testing along the fully-automated production line to assure each piece of module the best performance.

KEY FEATURES



Excellent module efficiency up to: 20.35%



IP68 junction box for long-term weather endurance



Heavy snow load up to 5400 Pa, wind load up to 3600 Pa



PID: Selected material and stringent quality system ensure PID free



Applicable to harsh environment of deserts, farmlands and seashores



Much lower risk of Hot Spot

CERTIFICATE

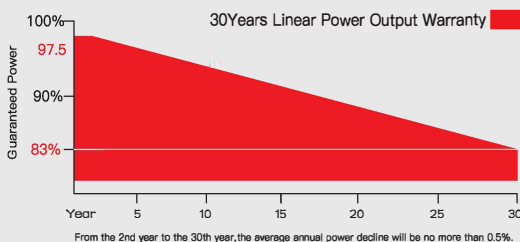

WARRANTY



Linear power output warranty
-12 years minimum 92% power output
-30 years minimum 83% power output



Product warranty on materials and workmanship
According to the applicable Einnova Solarline Limited Warranty Statement

China Jiangsu
International Group Ltd.

5 West Beijing Road,
Nanjing, 210008, China

+86-(0)25-84792033
+86-(0)25-84705923

info@einnova-solarline.com
www.einnova-solarline.com

EN

Ennova Solarline

invented for solar

DIMENSIONS OF PV MODULE (unit:mm)

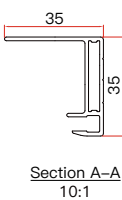
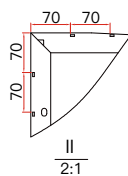
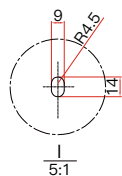
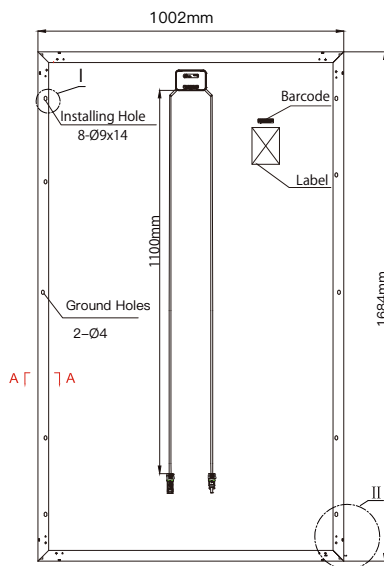
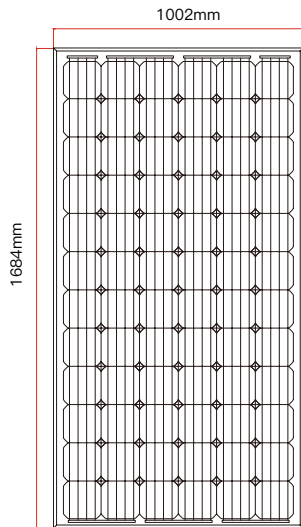

IV CURVE

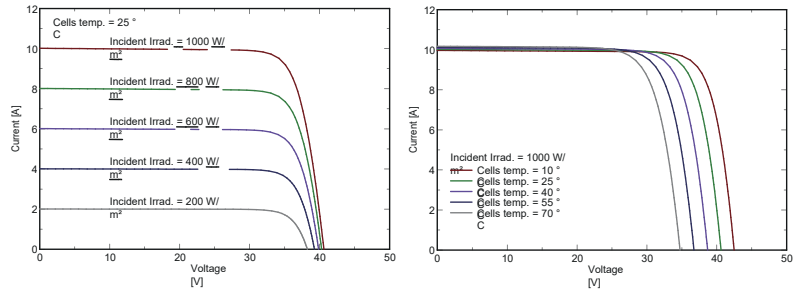

ELECTRICAL DATA@STC	ESM-325H	ESM-330H	ESM-335H	ESM-340H	ESM-345H
Pmax(with tolerance) [W]	325	330	335	340	345
Vmax [V]	33.34	33.43	33.51	33.59	33.69
IPmax [A]	9.75	9.87	10.00	10.12	10.24
Voc(with tolerance) [V]	40.25	40.30	40.35	40.40	40.45
Isc(with tolerance) [A]	10.28	10.42	10.56	10.70	10.84
Module Efficiency-ηm(%)	19.27	19.56	19.85	20.15	20.35
Maximum System Voltage	ICE 1500VDC/UL1500(VDC)				
STC:Irradiance:100W/m ² ,Module Temperature:25°C,Air Mass:1.5					

ELECTRICAL DATA@NOCT	ESM-325H	ESM-330H	ESM-335H	ESM-340H	ESM-345H
Pmax[W]	242.00	246.00	250.00	253.00	256.00
Vmp [V]	31.60	31.80	32.00	32.220	32.40
Imp [A]	7.66	7.74	7.82	7.86	7.92
Voc[V]	38.00	38.20	38.40	38.60	38.80
Isc[A]	8.54	8.65	8.74	8.86	8.98
NOCT:Irradiance:800W/m ² , Ambient Temperature:20°C,Air Mass:1.5,Wind Speed:1m/s					

MECHANICAL SPECIFICATIONS

Solar Cell Type	PERC Mono Crystalline Solar Module 158*158mm
Number of Cells	120pcs (20x6)
Module Size	1684*1002*35mm
Weight	20kg
Glass	3.2mm tempered glass
Back Sheet	White or Black
Frame	Anodized aluminium alloy,silver or black
Junction Box	IP68
Quantity of Diodes	3pcs
Cable	4.0mm ² 1000mm
Connector	MC4 Compatible
Wind/Snow Load	3600pa/5400pa

TEMPERATURE CHARACTERISTIC

NMOT (Nominal Module Operating Temperature)	45°C (±3°C)
Temperature Coefficient of Pmax	- 0.41%/°C
Temperature Coefficient of Uoc	- 0.32%/°C
Temperature Coefficient of Isc	0.05%/°C

PACKAGING CONFIGURATION

Modules per box:	30 pieces
Number per 20GP:	360 pieces
Modules per 40' HQ:	845 pieces

MAXIMUM RATINGS

Operational Temperature	-40 to +85°C
Maximum System Voltage	1500V DC(IEC) 1500V DC (UL)
Max Series Fuse Rating	20A
Snow Load	5400 Pa (3600 Pa)
Wind Load	3600 Pa (1600 Pa)

*design load with safety factor 1.5
(DO NOT connect Fuse in Combiner Box with two or more strings in parallel connection)